



RICHMOND BRIDGE
RESIDENTIAL

King Street
Twickenham
£1,095.00



39A KING STREET PARADE KING STREET TWICKENHAM TW1 3SG
APPROX. 57.4 SQ. METRES (617.4 SQ. FEET)

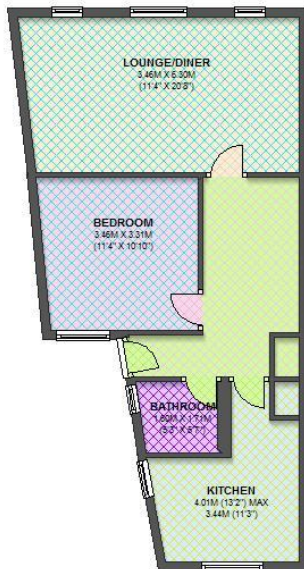

TOTAL AREA: APPROX. 57.4 SQ. METRES (617.4 SQ. FEET)

PROPERTY DETAILS

Located in the heart of Twickenham Town Centre, a spacious 1 bedroom furnished flat with allocated off street parking for one car. Walking distance of Twickenham station and easy access to the A316 for commuters to central London

- 1 Double bedroom
- Lounge/dining room
- Kitchen
- Bathroom/w.c.
- To be recarpeted throughout
- Allocated off Street Parking

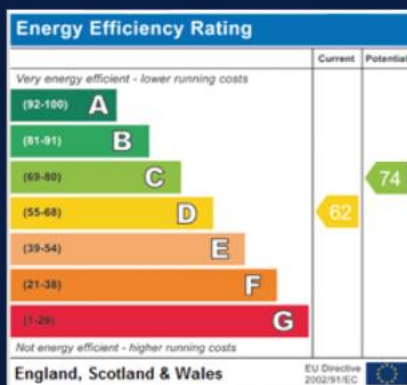

TO BOOK A VIEWING:

E: lettings@rbresidential.com

T: 020 8892 2244

See all our properties on our website

www.rbresidential.com

